



Magic Box

Electrical Performance:
CEI EN 60529

Degree of protection: IP68
Class 2 in accordance
with CEI 64-8.

Gel: UL 94-HB  US

Operating temperature  90°

Gel operating temperature 
-60°C / +200°C

HF *Halogen Free*

in accordance with
CEI EN 50267 2-2

IP68
OFFICIALLY
TESTED 

IP68 Connection kit complete with Magic Fluid insulating gel.

Universal IP68 kit without shelf life, mechanically robust, non-toxic, suitable for installation even in the most extreme conditions, re-enterable, meeting all international standards. Protects from water, moisture, dust and accidental contact caused by small animals.

- Re-enterable even after long periods of operation
- Able to absorb external shock without fracturing
- For installations even at high depths
- Also suitable for vertical filling
- No shelf life
- Non toxic and safe



Magic Box is suitable for any kind of installation, even underground or directly submerged!

Magic Box is always re-enterable, even after long working periods!





Kit box installation sequence

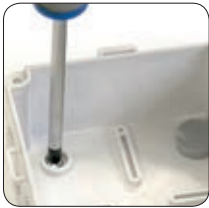

Fix the box and cover the screws with the caps.



Knock out the pre prepared holes.



Install the cable glands.



Insert the cables and connect the wires.

Horizontal installation sequence

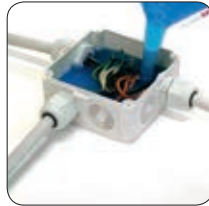

Vertical installation sequence



Examples of application

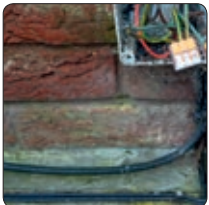

PUBLIC LIGHTING



NAVAL SECTOR



OUTDOOR - GARDENS

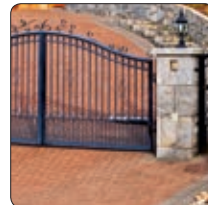

ELECTRIC GATES

Magic Box

Product	Max external Ø housed in input cables (mm)	N° and type of cable glands	Internal kit dimensions (mm)	Composition Kit
Magic Box 65	22	3 x PG16	Ø 65 x h 35	Kit complete with cover
Magic Box 80	22	3 x PG16	Ø 80 x h 40	
Magic Box 100	20	3 x M25 x 1.5	100 x 100 x h 50	3 cable glands
Magic Box 120	20	3 x M25 x 1.5	120 x 80 x h 50	Series of closing plugs
Magic Box 150	26	3 x M25 x 1.5	150 x 110 x h 70	Insulating gel for complete filling
Magic Box 190	26	3 x M25 x 1.5	190 x 140 x h 70	
Magic Box 240	26	3 x M25 x 1.5	240 x 190 x h 90	



**Ray
tech**