

RAPID JOINT

Radial closing gel pre-filled joint for extruded insulation cables up to 1 kV.

Made with self-extinguishing material, flame retardant, for cables at 90°C working temperature. The radial closing system facilitates joint application, making them re-enterable only by means of a tool.

ADVANTAGES

- ▶ For straight connections (in line).
- ▶ With suitable spacers.
- ▶ For all types of application, including submersible.
- ▶ Wide range of cable formations.
- ▶ Pre-filled with a gel that is not-classified as hazardous under the CLP Directive and with no shelf life.

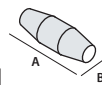
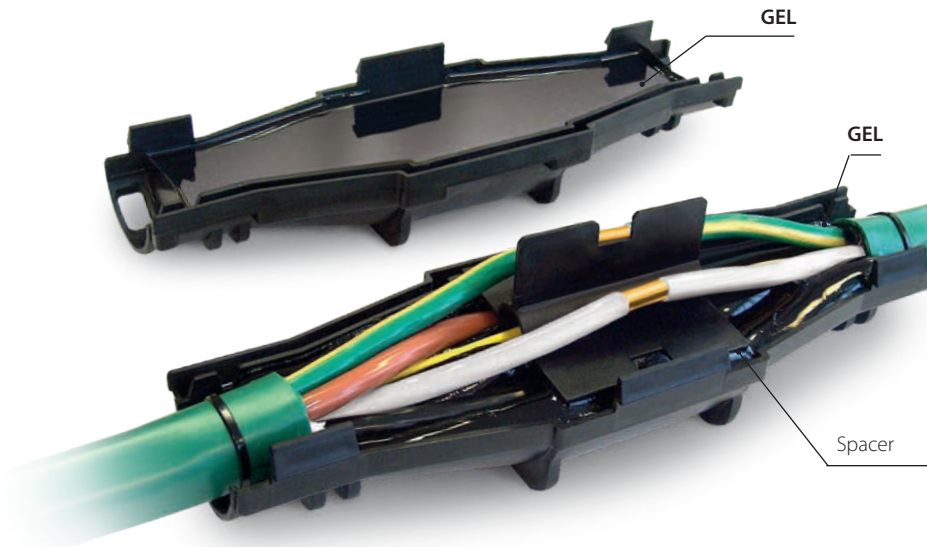

| PRODUCT / Item | Cable formation and conductor cross sections (n° x mm ²) | | | | With fiber-optic separator 4x | Dimension (mm) |
|--------------------------------------|--|----------|----------|----------|----------------------------------|----------------|
| | 1x | 2x | 3x | 4x | | |
| For COPPER cables | | | | | | |
| RAPID JOINT L6 301098-037 | 1,5 - 50 | 1,5 - 10 | 1,5 - 10 | 1,5 - 6 | - | 105 x 55 |
| RAPID JOINT L10 301098-004 | 2,5 - 150 | 2,5 - 25 | 2,5 - 16 | 2,5 - 16 | - | 180 x 60 |
| RAPID JOINT L25 301098-006 | 120 - 240 | 6 - 50 | 6 - 35 | 4 - 35 | - | 210 x 65 |
| RAPID JOINT L95 301098-003 | 185 - 400 | 35 - 95 | 25 - 70 | 25 - 70 | 16 - 50 | 320 x 100 |
| For ALUMINIUM cables | | | | | | |
| RAPID JOINT L25 301098-006 | 120 - 150 | 16 - 35 | 10 - 25 | 10 - 25 | - | 210 x 65 |
| RAPID JOINT L95 301098-003 | 185 - 400 | 35 - 95 | 25 - 70 | 25 - 70 | 16 - 50 | 320 x 100 |

Electrical performance:

- CEI EN 50393 with connectors complying with EN 61238-1
- Class 2 in accordance with CEI 64-8.

🔹 **Gel:** UL 94-HB **US**

🔹 **Casing mix:** UL 94-V2

🔧 **Working temperature:** 90°

🔧 **Installation temperature:** -40°C / +50°C

🌊 **Fully submersible**

🔑 **Can be used underground**

🌿 **Halogen-free Gel**

🔥 **No flame propagation:**
CEI 20-35 • IEC 60332-1 • HD405-1
(as applicable)

● **Degree of protection:** IPX8



Joint supplied with armor continuity device

RAPID JOINT S/ARM

For screened or tape or wire armoured cables.

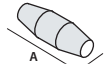

| For copper wire SCREENED cables | Cable formation and conductor cross sections (n° x mm ²) | | | | With fiber-optic separator 4x | Dimension (mm) |
|---|--|----------|----------|----------|----------------------------------|----------------|
| | 1x | 2x | 3x | 4x | | |
| RAPID JOINT L 10-S 301098-035 | 2,5 - 120 | 2,5 - 10 | 2,5 - 10 | 2,5 - 10 | - | 180 x 60 |
| RAPID JOINT L 25-S 301098-036 | 120 - 185 | 16 - 25 | 10 - 25 | 10 - 25 | - | 210 x 65 |
| RAPID JOINT L 95-S 301098-012 | 240 - 400 | 35 - 95 | 25 - 70 | 25 - 70 | 16 - 50 | 320 x 100 |

| For ARMoured cables | 1x | 2x | 3x | 4x | (mm) |
|---|----------|----------|----------|---------|-----------|
| RAPID JOINT L 10-ARM 301098-10ARM | 2,5 - 10 | 2,5 - 10 | 2,5 - 10 | - | 180 x 60 |
| RAPID JOINT L 25-ARM 301098-25ARM | 16 - 25 | 10 - 25 | 10 - 25 | - | 210 x 65 |
| RAPID JOINT L 95-ARM 301098-016 | 35 - 95 | 25 - 70 | 25 - 70 | 16 - 50 | 320 x 100 |



RAPID JOINT LS

For signalling and control cables.

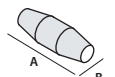

| PRODUCT Item | Conductors (mm ²) | Cable formation (n° conduttori) | | | | | | | | | | Dimension (mm) |
|--------------------------------------|----------------------------------|---------------------------------|----|-----|-----|-----|-----|-----|-----|-----|------|-------------------|
| | | 5x | 7x | 10x | 12x | 16x | 19x | 24x | 40x | 75x | 100x | |
| RAPID JOINT-LS1 301098-018 | 1,5 | • | • | • | • | • | • | | | | | 180 x 60 |
| | 2,5 | • | • | • | • | | | | | | | |
| RAPID JOINT-LS2 301098-019 | 1,5 | | | | | • | • | • | • | | | 210 x 65 |
| | 2,5 | | | • | • | • | • | | | | | |
| RAPID JOINT-LS3 301098-020 | 1,5 | | | | | | • | • | • | • | • | 320 x 100 |
| | 2,5 | | | | | | • | • | • | • | | |



RAPID JOINT T

Straight joints for telephone cables.

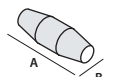

| UNscreened | SCREENED | N° pairs for conductor cross sections (n° x mm ²) | Dimension (mm) |
|---------------------------------------|--|---|----------------|
| PRODUCT / Item | PRODUCT / Item | | |
| RAPID JOINT-T26 301098-021 | RAPID JOINT-TS26 301098-024 | (1 - 26) x (0,5 - 0,6) | 180 x 60 |
| RAPID JOINT-T61 301098-022 | RAPID JOINT-TS61 301098-025 | (30 + 1 - 64 + 1) x (0,5 - 0,6) | 210 x 65 |
| RAPID JOINT-T101 301098-023 | RAPID JOINT-TS101 301098-026 | (60 + 1 - 100 + 1) x (0,5 - 0,6) | 320 x 100 |

RAPID JOINT SYSTEM FAST RP

Straight joint + Shear bolt connectors.

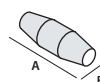
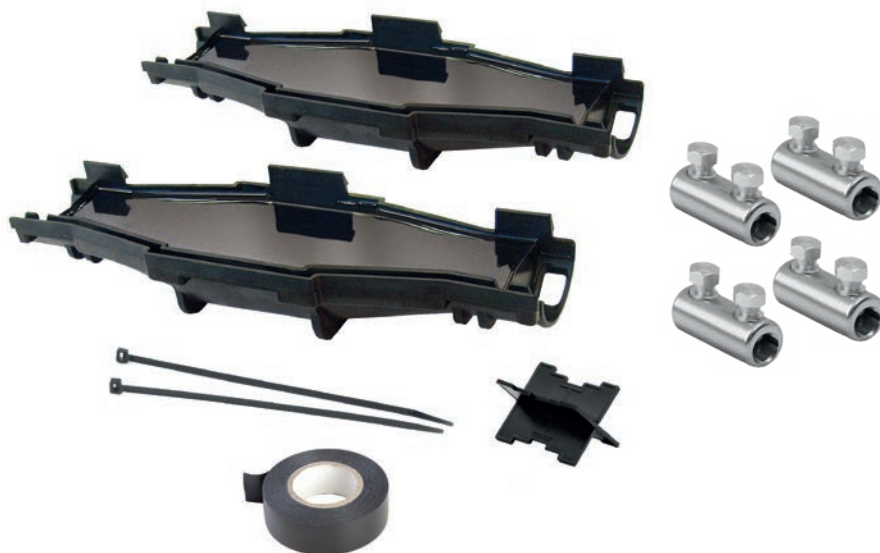

| PRODUCT / Item | Cable formation from 2x a 4x (n° x mm ²) | Dimension (mm) |
|---|---|-------------------|
| RAPID JOINT L 10 RP RAPIDJL10RP | 1,5 - 10 | 180 x 60 |
| RAPID JOINT L 25 RP RAPIDJL25RP | 10 - 25 | 210 x 65 |
| RAPID JOINT L 95 RP RAPIDJL95RP | 35 - 95 | 320 x 100 |

Shear bolt connectors

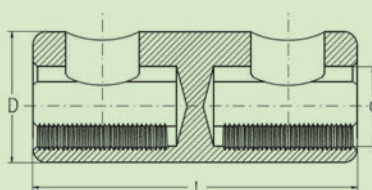

| PRODUCT / Item | Aluminium cross sections* (mm ²) | Copper cross sections (mm ²) | Breakaway torque (Nm) | Dimension | | |
|--|--|--|-----------------------------|-----------|-----------|------|
| | | | | L | D (mm) | d |
| RAY-TTF 1,5/16 RAY-TTF1,5/16 | 10 - 16 | 1,5 - 16 | 4 | 30 | 12 | 6,1 |
| RAY-TTF 10/35 RAY-TTF10/35 | 10 - 35 | 10 - 35 | 10 | 36 | 16 | 9,0 |
| RAY-TTF 25/50 RAY-TTF25/50 | 25 - 50 | 25 - 50 | 12 | 36 | 18 | 10,0 |
| RAY-TTF 35/150 RAY-TTF35/150 | 35 - 150 | 35 - 150 | 30 | 70 | 28 | 17,0 |

* For round conductors.